



R20LCY
Chiller

OASIS Remote Chillers deliver cold water on-demand. Designed to work under a sink, in remote installations or in a pressure drinking fountain, our water-friendly chillers dispense cold, fresh drinking water how and where you need it.

- Easy Installation
- Delivers 150 Litres Per Hour of chilled drinking water per hour
- Designed for remote or In-A-Wall installation
- Shelf support, wall mounting cradle and stainless steel ventilating grille at extra cost
- Waterways are lead-free in materials and construction
- High efficiency stainless steel cooling tank
- Made of heavy-gauge steel
- Refrigerant R-134a



MODEL CODE	R20LCY
TYPE	Remote or In-A-Wall
EXTERIOR	Heavy-guage steel
WATERWAYS	Lead-free
DIMENSIONS	457(H) x 278(W) x 594(D) mm
NET WEIGHT	35 kg
POWER SUPPLY	220-240V, 50/60 Hz
COOLING PERFORMANCE	150 LPH Rated Capacity & Base Rate (10°C in 21°C amb. temp.)
FULL LOAD AMPS	6.5 A
RATED WATTS	860 W
ENERGY SYSTEM	Refrigeration is on only when in use or if water temp increases during long period of standby.
COUNTRY OF ORIGIN	Mexico
CERTIFICATIONS	CE
WARRANTY	1 Year

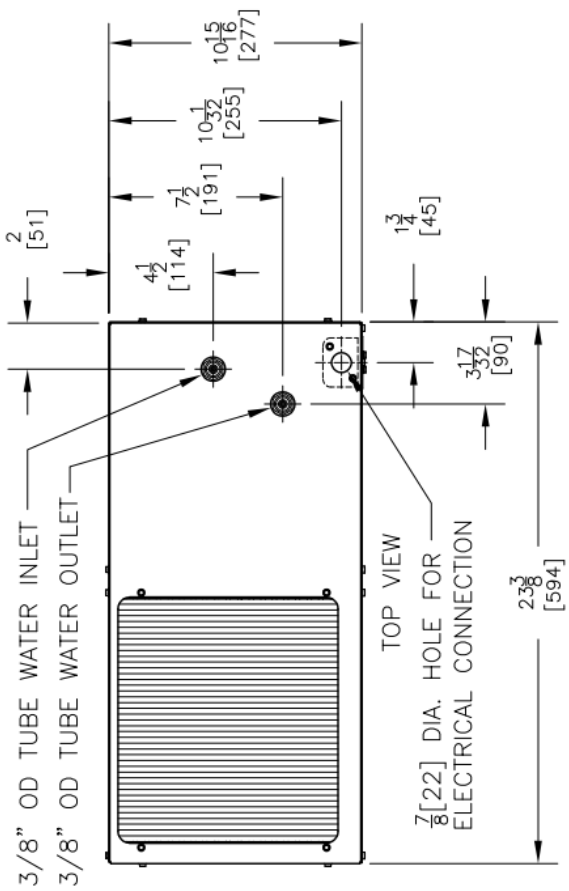

UNIT MUST BE INSTALLED WITH THIS SIDE UP

JUNCTION BOX COVER

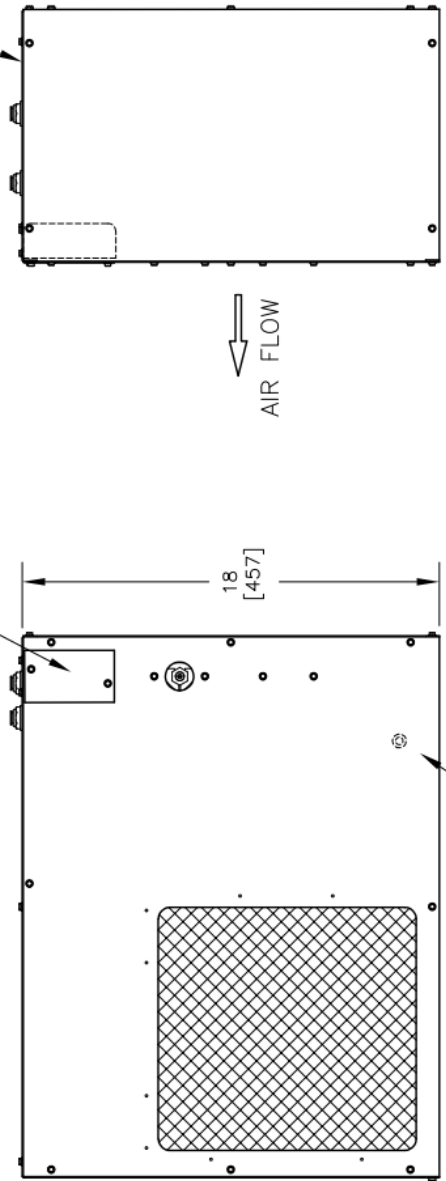

NOTES:

1. ALLOW 6 INCHES [152 MM] MIN. PER VENTILATED SIDE, 7 INCHES [178 MM] ABOVE UNIT.
2. ALL DIMENSIONS ARE IN INCHES. DIMENSIONS IN BRACKETS [] ARE IN MILLIMETERS.

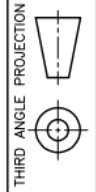

ROUGHING-IN AND DIMENSIONAL DRAWING



www.oasis.ie
www.oasisbottlefillers.com
info@oasis.ie

OASIS IRELAND
Bunree Industrial Estate, Ballina,
Co. Mayo, F26 D5R3, Ireland.
+353 96 71222

OASIS POLAND
ul. Gutenberga 20,
44-164, Gliwice, Poland
+48 32 332 65 01